

MINIMUM SPECIFICATIONS AND BID FORMS  
FOR  
CUTTING EDGES AND SHOES  
FOR GRADERS, PLOWS AND WINGS  
FOR  
CATTARAUGUS COUNTY DEPARTMENT OF PUBLIC WORKS  
HIGHWAY DIVISION

OFFICE OF THE CLERK  
CATTARAUGUS COUNTY LEGISLATURE  
303 Court Street  
Little Valley, NY 14755

## TABLE OF CONTENTS

	PAGE
Notice to Bidders.....	1
Instructions to Bidders.....	2
Detailed Specifications.....	5-15
Product Index Sheet .....	16
Product Index Bid Form.....	17
Non-Collusive Bidding Certification .....	18
Legal Status Information .....	19
Bid for Performance .....	20
Iran Divestment Act of 2012.....	21

# CATTARAUGUS COUNTY

## DEPARTMENT OF PUBLIC WORKS

*Development – Progress – Workmanship*

*Joseph T. Pillittere  
Commissioner*

*Kathleen M. Ellis  
Deputy Commissioner*

*Mark C. Burr, P.E.  
Director of Engineering*



*Jack Ellis Drive  
8810 Route 242  
Little Valley, New York 14755  
Phone (716) 938-9121  
Fax (716) 938-2753*

### ADVERTISEMENT FOR BIDS

Sealed bids for the purchase of certain materials, equipment, and/or services, for the Cattaraugus County Department of Public Works, according to specifications, will be received by the undersigned, at the Department of Public Works Facility, 8810 Route 242, Little Valley, New York, until **Thursday, August 17, 2017 at 1:45 P.M.** after which they will be publicly opened at **2:00 P.M.** (at the *same location*), by the undersigned, under the direction of the Public Works Committee of the Cattaraugus County Legislature. Each bid, at the time it is received, will be stamped showing date and time of receipt.

**ALL BIDS MUST BE SEALED AND CLEARLY MARKED:** (Delivered to the address above)  
Any bid not clearly marked will not be considered.

### **DPW BID #61 - Cutting Edges & Shoes for Graders, Plows & Wings**

Bidding sheets and instructions may be obtained online at [www.cattco.org/bid-request](http://www.cattco.org/bid-request), or at the Cattaraugus County Department of Public Works, 8810 Route 242, Little Valley, New York, 14755. Phone Dawn Smith at 938-9121 Ext. 2465.

All bids must be sent or delivered to Cattaraugus County Department of Public Works, 8810 Route 242, Little Valley, NY 14755, Attention: Dawn Smith.

All bids must be accompanied by a NON-COLLUSIVE BIDDING CERTIFICATE. Any bid submitted without such certification will not be accepted.

Any bid not meeting ALL specifications will not be considered. All bids received are subject to all federal and state controls concerning any such equipment, materials and/or services.

The County Legislature reserves the right to reject any or all bids, to waive any informalities, and to accept the lowest responsible bid.

John Searles  
County Administrator  
County Center - 303 Court Street  
Little Valley, New York 14755

# INSTRUCTIONS TO BIDDERS

## DPW MATERIALS

### 1. BID FORM

Bid shall be submitted on these Cattaraugus County bid forms or bid will not be considered. Bid must be typed or printed in ink. Original autograph signatures in ink are required. Facsimile or rubber stamp signatures will not be accepted. All blanks must be filled in with required information or, if a bid item, the designation N/B (no bid).

### 2. CHANGES

Any change in wording or interlineation by a bidder of the inquiry as published by Cattaraugus County shall be reason to reject the proposal of such bidder, or in the event that such change in the Invitation to Bid is not discovered prior to entering into a contract, to void any contract entered into pursuant to such bid.

### 3. INFORMALITIES

The County may consider informal any bid not prepared and submitted in accordance with the provisions hereof and may waive any informalities or reject any and all bids. The contract award will be made to the responsible bidder submitting the lowest acceptable bid. Conditional bids will not be accepted.

### 4. BID TIME

Any bid may be withdrawn prior to the above scheduled time for the opening of bids, or authorized postponement thereof. Any bid received after the time specified shall not be considered.

### 5. INVESTIGATIONS

The County may make such investigations as it deems necessary to determine the ability of the bidder to perform the work, and the bidder shall furnish to the County all such information and data for this purpose as the County may request. The County reserves the right to reject any bid if the evidence submitted by, or investigation of, such bidder fails to satisfy the County that such bidder is properly qualified to carry out the obligations of the contract and to complete the work contemplated therein.

### 6. BID ENVELOPE

Each bid must be submitted in a sealed envelope clearly marked as to contents therein, bearing on the outside the name and address of the bidder. If sent by mail, the sealed envelope containing the bid must be enclosed in another envelope labeled as specified.

### 7. NON-COLLUSIVE CERTIFICATION

Non-collusive bidding certification shall be made by each bidder in the form provided and shall be submitted as a part of the bid. Bids submitted without non-collusive bidding certification will be considered irregular and may be rejected by the County.

### 8. CONTRACT AWARD

Contract(s) or purchase order(s) will be awarded after due consideration of the suitability of goods and/or services bid to satisfy these specifications, the total cost of such goods and/or services including all cost elements, and the timeliness of the agreed delivery date.

### 9. REFERENCES

A list of references for whom the bidder has done work in the past must accompany the bid. If a bidder cannot provide a list of references, including at least one reference located in Western New York, the County reserves the right to require a performance bond in an amount to be determined by the Public Works Committee in a format acceptable to the County Attorney. The cost of such bond shall be absorbed by the bidder.

### 10. EXECUTORY CLAUSE

This executory clause shall be a part of any agreement entered into pursuant to this bid:

It is understood by the parties that this agreement shall be executory only to the extent of the monies available to the County of Cattaraugus and appropriated therefor, and no liability on account thereof shall be incurred by the County beyond the monies available and appropriated for the purpose thereof.

### 11. DELIVERY SCHEDULE

Failure to meet delivery schedule as per accepted bid may result in legal action by Cattaraugus County to recover damages.

### 12. PRICES

Prices shall be quoted F.O.B. destination delivered inside and installed, or in the manner mentioned in specifications. "Tailgate delivery" will not be accepted unless specified by the County.

### 13. TRANSPORTATION CHARGES

Collect transportation charges will not be paid by the County. All freight, cartage, rigging, postage or other transportation charges shall be prepaid, unless otherwise stated in the Detailed Specifications herein.

### 14. TAXES

No taxes are to be billed to the County. Bid shall not include any Federal, State, or local excise, sales, transportation, or other tax unless Federal or State law specifically levies such tax on purchases made by a political subdivision. Any applicable taxes from which the County is not exempt shall be listed separately as cost elements, and added into the total net bid.

15. COMPLIANCE WITH LAWS

The successful bidder shall comply with all laws, rules, regulations and ordinances of the Federal Government, the State of New York and any other political subdivision or regulatory body which may apply to its performance under this contract.

16. DISCRIMINATION

The successful bidder agrees:

- (a) that in the hiring of employees for the performance of work under this contract or any subcontract hereunder, no contractor, subcontractor, nor any person acting on behalf of such contractor or subcontractor, shall by reason of race, creed, color, sex or national origin discriminate against any citizen of the State of New York who is qualified and available to perform the work to which the employment relates;
- (b) that no contractor, subcontractor, nor any person on his behalf shall, in any manner, discriminate against or intimidate any employee hired for the performance of work under this contract on account of race, creed, color, sex or national origin;
- (c) that there may be deducted from the amount payable to the contractor by Cattaraugus County under this contract a penalty of fifty dollars for each person for each calendar day during which such person was discriminated against or intimidated in violation of the provisions of the contract;
- (d) that this contract may be canceled or terminated by Cattaraugus County and all monies due or to become due hereunder may be forfeited, for a second or any subsequent violation of the terms or conditions of this section of the contract; and
- (e) the aforesaid provisions of this section covering every contract for or on behalf of Cattaraugus County for the manufacture, sale or distribution of materials, equipment or supplies shall be limited to operations performed within the territorial limits of the State of New York.

(N.Y. State Labor Law Article 8 Section 220-e)

17. CONTRACT ASSIGNMENTS

The bidder shall not assign, transfer, sublet, or otherwise dispose of this contract, or of its right, title or interest in the contract, or its power to execute the same, to any other person or corporation without the previous consent, in writing, of the Chairman of the Cattaraugus County Legislature.

18. CASH DISCOUNT

Any cash discount which is a part of a bid will be considered as a reduction in the bid prices in determining the award of the bid. Date of invoice must not precede date of delivery. The County policy is to pay all claims in a timely manner within the specified time. However, if for some reason payment is delayed, the County will take the discount when payment is made. If this is unsatisfactory, please quote net. The County will not pay any interest charges.

19. MANUFACTURERS

Where required on an individual bid sheet, the bidder must specify the trade name of the material on which the price is quoted.

20. ALTERNATE MANUFACTURERS

Bid offering material other than that of specified manufacturer or trade name will be considered unless stated otherwise. The use of the name of a particular manufacturer, trade name, or brand in describing an item does not restrict a bidder to that manufacturer or specific article. However, the substituted article on which a proposal is submitted must be of such character or quality that it would serve the purpose for which it is to be used equally as well as the manufacturer or brand specified. Proposals will be accepted in accordance with specifications on file or approved equal.

21. ALTERNATE ITEMS

If material or services other than those specified in this bid document are offered, the bidder must so state and furnish at the time of bid opening, if so requested, and as part of his bid the following information in duplicate:

- (a) Complete description of the item offered, and detailed explanation of the differences between the item specified and the item offered. If, in the opinion of the Department Head, sufficient detail is not presented as a part of the sealed bid to permit definite evaluation of any substitute item, the bid will not be considered.
- (b) Descriptive literature of item offered, for evaluation.
- (c) List of installations in Cattaraugus County of the item offered.
- (d) List of other installations.

22. ADDITIONAL INFORMATION

Any additional information which bidder desires to add to the bid shall be written on a separate sheet of paper, attached to, and submitted with, the formal sealed bid, to be read at the formal opening.

23. WORKMANSHIP

Workmanship must meet with the approval of the department head or heads involved, and shall be first class in every respect without exception and shall be equal to the best modern practices. Materials furnished are to be new and unused. All materials furnished or work performed are to be guaranteed free from defects. Anything found defective or not meeting specifications, no matter in what state of completion, may be rejected and shall be made good by the bidder at his own expense.

24. HOLD HARMLESS

The successful bidder to whom the bid is awarded shall indemnify and hold harmless Cattaraugus County and its agents and employees from and against all claims, damages, losses or causes of action arising out of or resulting from such vendor's performance pursuant to this bid.

25. BID VALIDITY

This bid is firm and irrevocable for a period of 45 days from the date and time of the bid opening. If a contract is not awarded within the 45 day period, a bidder to whom the bid has not been awarded, may withdraw his bid by serving written notice of his intention to do so upon the Clerk of the County Legislature. Upon withdrawal of the bid pursuant to this paragraph, the County will forthwith return the bidder's security deposit.

26. CONTRACT INTEREST

No official, or employee of the County, who is authorized in such capacity, and on behalf of the County, to negotiate, make, accept or approve or to take part in negotiating, making, accepting, or approving this contract shall become directly or indirectly interested personally in this contract or in any part hereof. No officer or employee of, or for the County, who is authorized in such capacity, and on behalf of the County, to exercise any supervisory, administrative, or other function, in connection with this contract, shall become directly or indirectly interested personally in this contract or in any part hereof.

27. OTHER CUSTOMERS

Prices charged to Cattaraugus County are to be no higher than those offered to any other governmental or commercial consumer. If a bidder has a New York State or a Federal GSA contract for any of the items covered in this bid or any similar items, he shall so indicate that he has said contract on these bid papers and supply a copy of this contract within 5 days if so requested by the County.

28. PRICE IS FIRM

The unit prices bid shall remain firm, and any other charges bid shall also remain firm, for delivery of the equipment, material, work, or services described in this bid with the exception of the asphalt, aluminum, propane gas, diesel fuel, kerosene and gasoline bids, which are permitted escalator prices in accordance with the detailed specifications for those products. No cost increase shall be charged for any reason whatsoever.

29. BIDDER AFFIRMATION

In executing this bid, the bidder affirms that all of the requirements of the specifications are understood and accepted by the bidder, and that the prices quoted include all required materials and services. The undersigned has checked all of the bid figures, and understands that the County will not be responsible for any errors or omissions on the part of the undersigned in preparing this bid. Mistakes or errors in the estimates, calculations or preparation of the bid shall not be grounds for the withdrawal or correction of the bid or bid security. In case of error in extension of prices in the bid, the unit price will govern.

30. STATE CONTRACTS:

The County reserves the right to purchase the commodity being bid, from State Contract when it is most beneficial to the County to do so.

31. LITIGATION:

In the event any litigation shall arise from this contract, the laws of the State of New York shall control any litigation, regardless of which party shall institute such action.

32. MUNICIPAL EXTENSION:

The contract if awarded will be to the lowest responsive/responsible bidder(s) in part or in whole who meet(s) all the terms of the specifications. The County guarantees no minimum or maximum purchases or contracts as a result of award of this bid. Cattaraugus County reserves the right to allow all municipal and not for profit organizations authorized under the General Municipal Laws of the State of New York, to purchase any goods (materials and equipment) and/or services awarded as a result of this bid in accordance with the latest amendments to NYS GML 100 through 104 and County Law Section 408-a. However, it is understood that the extension of such contracts are at the discretion of the vendor and the vendor is only bound to the contract between Cattaraugus County and the vendor.

33. ALTERNATE SOURCE:

Where a New York State bid or a bid from another municipality results in an award for an item herein at a total price which is more favorable than that of the bidder to whom an award is made herein, and such price is available to County, County reserves the right to purchase from the State bid or from such other, alternate bid, notwithstanding its award to the lowest responsible bidder herein, after offering the County bid awardee an opportunity to meet or better the item price.

**MINIMUM SPECIFICATIONS FOR  
CUTTING EDGES FOR GRADERS,  
PLOWS, AND WINGS**

REVISED 7/17

**NOTE:**

**PRICE ADJUSTMENTS:**

At no time may the contract pricing changes be raised in excess of the Consumer Price Index OR Producer Price Index as calculated by Cattaraugus County. Prices covered under this bid or any extensions thereof shall not be raised more than once per item in a twelve month period. No prices shall be raised within the first six months of the contract or any renewal extension. If, in the opinion of the County, any price alteration request is in excess of that acceptable to the County, the County reserves the right to seek new pricing for that item(s) or the entire bid as covered by GML 103 and 104b. The burden of proof of such adjustment is the sole responsibility of the vendor.

**SPECIFICATIONS**      Cutting Edges for shoes for GRADERS, PLOWS, WINGS

**CONTRACT**      October 1, to September 30, of the following year.

**QUANTITY**      Indefinite - as required

**DELIVERY**      30 days F.O.B. any point in Cattaraugus County, N.Y.

**MATERIAL**      Steel analysis for all cutting edges shall be S.A.E. 1080-1090 carbon steel with Brinell hardness of 250-325 unless otherwise stated.

**PRODUCT REFERENCES "Or Equal"**

The County shall be the sole judge as to whether a proposed equivalent or substitution is to be approved and the bidder shall have the burden of proving same, at his own expense, to the satisfaction of the County. Any deviations shall be noted with explanations of change including equipment name brand, etc. Deviations shall be equal or better and so noted throughout specifications.

**AWARD**

- a.) Cattaraugus County reserves the right to accept or reject any or all bids, to waive bid inconsistencies, and to accept the bids deemed most advantageous to the County in accordance with General Municipal Law. Explanations of County decisions shall not be required except as otherwise provided for by law.
- b.) The award will be made to the lowest responsible bid meeting specifications for the commodities proposed, taking into consideration the reliability of the bidder, the quality of the materials, services, equipment, or supplies to be furnished, their conformity with the specifications, the purposes for which required, and the terms of delivery.
- c.) Samples may be requested by the County. After acceptance of the sample the delivered material must be the same as the sample provided. See "SAMPLE." Product Substitution, revisions, or alterations in materials or manufacturing, WILL NOT be permitted or accepted and result in termination of awarded contract. Additional costs incurred due to failure to supply awarded product will be borne solely by vendor.
- d.) Multiple awards are possible when Bid Proposal(s) Form is broken into different categories/groups mandating such. All terms and conditions apply to each separate award.
- e.) Where Vendor would like to bid more than 1-brand for same group; copy bid form and designate that form as "Alternate Bid"

**SAMPLE**

- a.) Samples, when required, must be submitted strictly in accordance with instructions, otherwise, bid may not be considered. If samples are requested subsequent to bid opening, they shall be delivered within ten (10) days of the request, or as directed, for bid to have consideration. Samples must be furnished free of charge and must be accompanied by descriptive memorandum invoices indicating if the bidder desires their return and specifying the address to which they are to be returned provided they have not been used or made useless by test. **Award samples may be held for comparison with deliveries. After sample has been accepted the delivered product must be the same as the sample that was provided.** The County will not be responsible for any samples destroyed or mutilated by examination or testing. Samples shall be removed by the bidder at his

expense. Samples not removed within fifteen (15) days after written notice to the bidder will be regarded as abandoned and the County shall have the right to dispose of them as its own property.

**PRICES**

**ALL PRICING IS TO BE FIGURED ACCORDING TO THE ORDER SIZE, PER SHOE OR BLADE, AND NOT ACCORDING TO WEIGHT, AND PLACE ON PAGE 17.**

The County will NOT PAY additional service or delivery charges such as "FUEL SUR-CHARGES".

**EACH PRODUCT WILL HAVE AN "INDEX NUMBER", USED ON PAGE 16.**

\*\*\*\*\*

**A - CARBON GRADER BLADES**

(sheared, mitered, and punched)  
hole type, size and spacing as per order

Carbon Grader - double bevel curved Item - price per foot

5/8" x 8"

**B - CARBON PLOW & WING BLADES**

(Round Hole type, drilled for 5/8 cap screw 12" centers)  
Carbon plow & wing blades Item – Price per foot

3/4" x 6"

(Material - Steel analysis for cutting edges will be carbon .70 - .80 with minimum Brinell hardness 600.)



## Center Punched



## Center Punched



## **E - TUNGSTEN CARBIDE BLADES FOR PLOWS AND GRADERS**

Acceptable brands/part #'s or latest revision thereof; Kennametal PB136 & PB148.

### **1. BLADE**

- 1.1 The blade shall be flat hot-rolled finished steel to meet or exceed specifications for A36 or 1020 type steels.
- 1.2 Punching shall be 1 1/16" square holes with countersink to receive 5/8" diameter plow bolts. Location and spacing of the holes shall be as specified by the user.
- 1.3 The groove for the carbide inserts shall be milled in the center of the blade edge.
- 1.4 Center of holes shall be in line within 1/32" of established horizontal centerline and 1/16" of established vertical centerline.

### **2. TUNGSTEN CARBIDE INSERTS**

- 2.1 The inserts shall be a high shock WC grade of tungsten carbide with (11 to 12 1/2) percent cobalt content.  
Density: 14.1 Minimum to 14.6 Maximum  
Hardness: 87.5 Minimum to 89.0 Maximum  
Rc. "A" Scale  
Transverse Rupture Strength (p.s.i.): 350,000 Minimum  
Porosity: (Based on testing in accordance with ASTM designation B276-79)  
A06  
B02  
C00
- 2.2 The carbide insert manufacturer to furnish certification to the State Highway Department that the inserts meet the specifications as set forth in 2.1.
- 2.3 The inserts shall be a trapezoid design of the following dimensions:  
Height: .635" +/- .005 (long side)  
Width: .365" +/- .010  
Length: 1" Nominal  
Bottom Angle: 25 degrees with a nose radius of 1/16" minimum
- 2.4 A metallurgical evaluation of the carbide insert shall show no evidence of cross grade contamination. Evaluation to be based on a photomicrograph of a polished and etched specimen at 500x magnification.

### **3. BRAZING**

- 3.1 The brazing material shall be a high strength alloy type.
- 3.2 The tungsten carbide inserts shall be positioned in the milled groove at approximately .010 between the inserts the entire length of each cutting edge section.
- 3.3 The inserts shall be brazed on all sides consistent with sound brazing practice with no evidence of voids or use of shims.
- 3.4 Each blade section to contain one insert, one inch nominal length for each inch of blade section length. Due to the thickness of the braze joints between inserts it may be necessary for several inserts to be slightly shorter or longer than the nominal 1" length to insure the carbide insert runs the entire length of the blade without protruding from the end of the steel body.

### **4. SPECIFIC REQUIREMENTS**

- 4.1 The difference between the highest and lowest tip point (on any two adjacent inserts) not to exceed 1/32" on any given blade assembly.
- 4.2 The finished blade section shall be free of warpage and longitudinal deviation not to exceed 1/8" in a four-foot blade section.
- 4.3 Each blade section shall be identified with manufacturer's identification stamp.
- 4.4 The finished blade sections shall have marking showing the front edge of the blade to avoid improper mounting.

### **5. TYPE I - Price per set**

3 piece set No. D.B. 48-36-48 carbide plow blade (round holes)

## **F - RUBBER SNOW PLOW/WING BLADES**

Wing Blade, Extruded & Vulcanized Styrene-Butadiene Rubber:

Minimum Tensile Strength (ASTM D-412): 2,145 PSI

Minimum Elongation (ASTM D-412): 519%

Modulus @ 300% Elongation (ASTM D-412): 1,001 PSI

Hardness-Shore A.Duro (ASTM D-2240): 62

Specific Gravity (ASTM D297): 1.19

1.5 inch by 10 inch by 11 feet

Standard Highway Punch - Slotted

## **PLOW and WING SHOES**

for Viking Plow

## **G - PLOW SHOE**

2 1/4" x 8" x 14"

Min. weight 36 lbs.

Hole size 13/16" recessed for  
square head bolt.

A) CAST ALLOY ABRASIVE SHOES must meet or exceed minimum surface hardness of 475 Brinell, minimum core hardness 325 Brinell, minimum tensile strength 45,000 PSI, minimum impact strength Charpy, 28 ft. lbs., minimum density 25 lbs per cubic inch.

## **H - WING SHOE (CAST ALLOY)**

12" 10 Degree

Min. weight 37 lbs.

Hole size 3/4"

A) CAST ALLOY ABRASIVE SHOES must meet or exceed minimum surface hardness of 475 Brinell, minimum core hardness 325 Brinell, minimum tensile strength 45,000 PSI, minimum impact strength Charpy, 28 ft. lbs., minimum density 25 lbs per cubic inch.

**I - NIHARD WING SHOE (see attached drawing)**

8" Center Punched  
3/4" x 12" O/C,

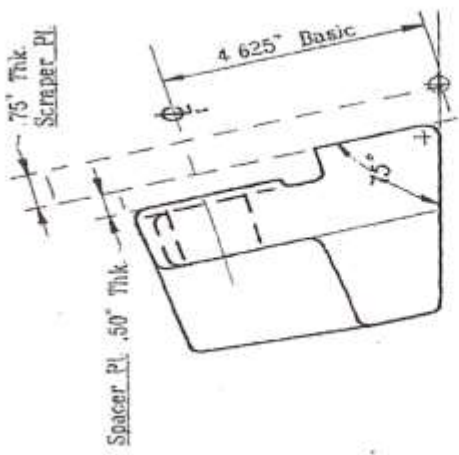
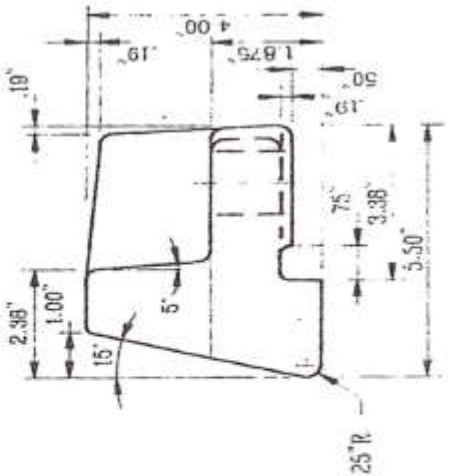
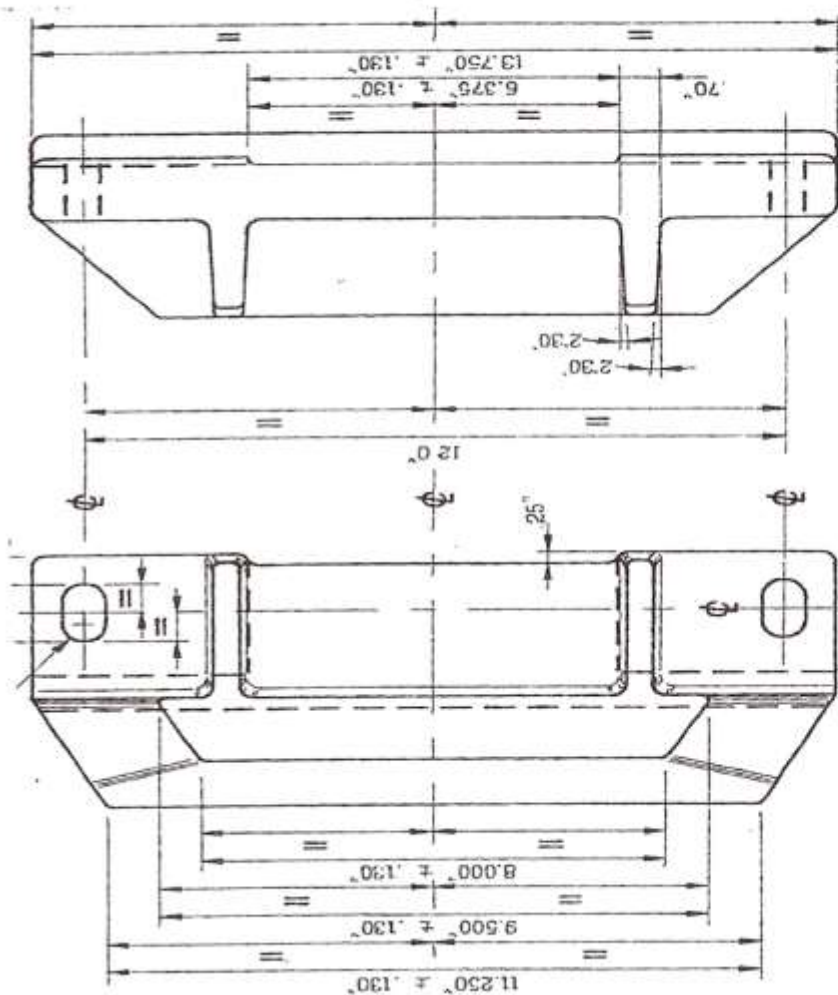

Quality Specifications	N301-34
- Material : Cr-Ni Alloy	Nihard Wing Shoe
C: min 2.7 - max 3.2	Cr: min 12
Mn: min 0.5 - max 0.7	P+S: max 0.1
Ni: min 0.2 - max 0.5	- Hardness: 500 HB min
Si: min 0.4 - max 1.0	- Dark Blue Surface Coating

## (Kennametal KCWB 0167 or approved equal)

Carbide inserts shall be bonded to the shoe by either brazing or being cast in to place And Run Lengthwise.

A metallurgical evaluation of the carbide insert shall show no evidence of cross grade contamination. Evaluation is to be based on a photomicrograph of a polished and etched specimen at 500X magnification. Inserts to be a high shock WC grade of tungsten carbide with a 11-12.5% cobalt content; Density of 14.0 Minimum – 14.6 Maximum; Hardness between 87.5 Minimum – 89.0 Maximum RC. “A” Scale; Minimum Transverse Rupture Strength 350,000 psi; Porosity (based on testing in accordance with ASTM designation B276-79) A06, B02, COD.

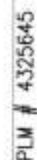

**K - NIHARD MOLDBOARD SHOE** (see attached drawing)

- C: Min 2.7 – max 3.2
- Mn: min 0.5 –max 0.7
- Ni: min 0.2 – max 1.5
- Si: min 1.4 – max 1.0
- Cr: min 12
- P+S: max 0.1
- Hardness: 500 HB min
- Dark Blue Surface Coating

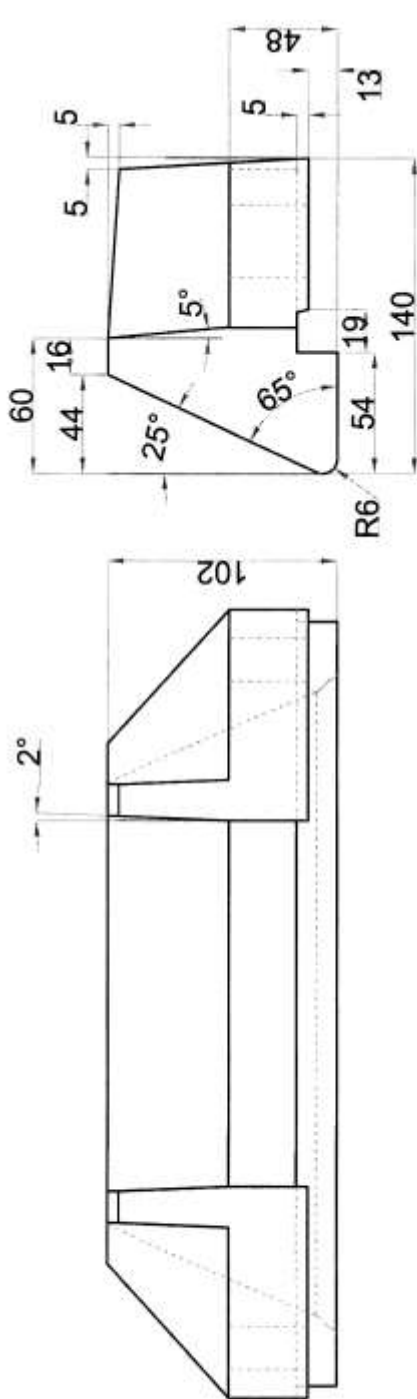

Quality Specifications	N301-34A
- Material : Cr-Ni Alloy	Nihard Moldboard Shoe
C: min 2.7 - max 3.2	Cr: min 12
Mn: min 0.5 - max 0.7	P+S: max 0.1
Ni: min 0.2 - max 0.5	- Hardness: 500 HB min
Si: min 0.4 - max 1.0	- Dark Blue Surface Coating

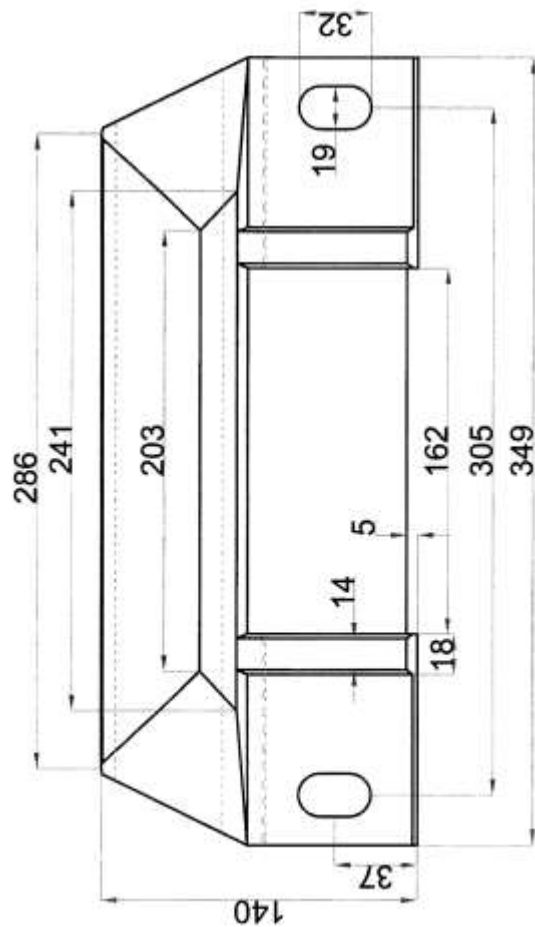

**L - NIHARD MUSHROOM SHOE** (see attached drawing)

C: Min 2.7 – max 3.2  
Mn: min 0.5 –max 0.7  
Ni: min 0.2 – max 1.5  
Si: min 1.4 – max 1.0  
Cr: min 12  
+S: max 0.1  
Hardness: 500 HB min  
-Dark Blue Surface Coating

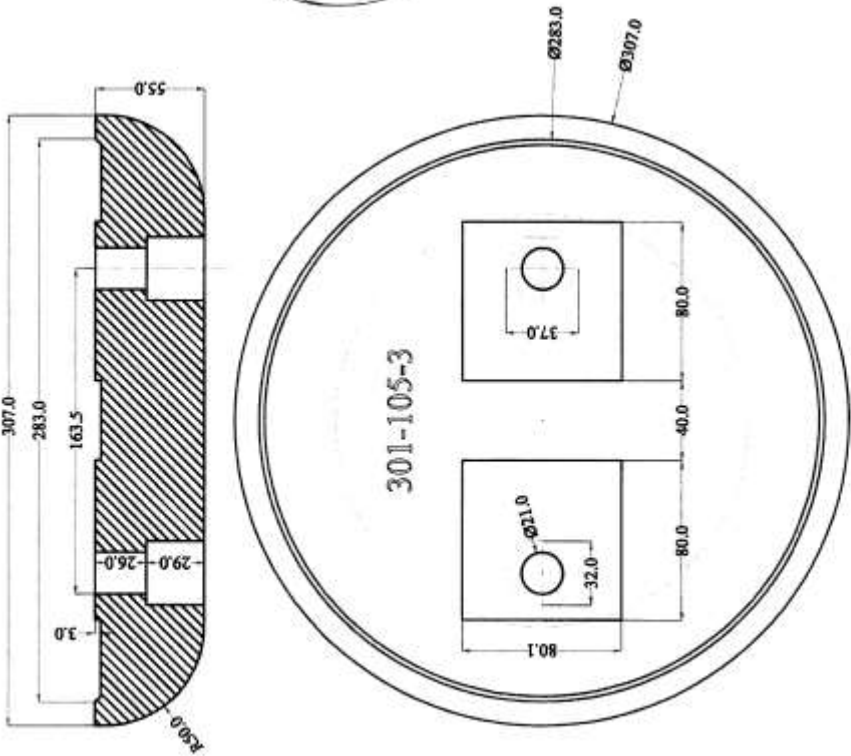

Quality Specifications	N301-105-3
- Material : Cr-Ni Alloy	Nihard Mushroom Shoe
C: min 2.7 - max 3.2	Cr: min 12
Mn: min 0.5 - max 0.7	P+S: max 0.1
Ni: min 0.2 - max 0.5	- Hardness: 500 HB min
Si: min 0.4 - max 1.0	- Dark Blue Surface Coating



**V - PLOW NOSE PIECE**

Fit Viking One Way Snow plow  
(used for older model plows)

Viking Model #10803091 (or equal)

**W - PLOW NOSE PIECE**

Fit Viking One Way Snow plow  
(used for newer model plows)

Viking Model #10805373 (or equal)

**PRODUCT INDEX SHEET**  
**CUTTING EDGES FOR GRADER, PLOWS, AND WINGS**

INDEX NO.	DESCRIPTION
A =	<b><u>CARBON GRADER BLADES</u></b> (sheared, mitered and punched) hole type, size and spacing as per order Carbon Grader - double bevel curved Item <b>PRICE PER FOOT:</b>
A-8L	5/8" x 8" LESS THAN 10 SETS
A-8G	5/8" x 8" 10 SETS & GREATER
B =	<b><u>CARBON PLOW &amp; WING BLADES</u></b> (Round Hole type, drilled for 5/8 cap screw 12" centers) Carbon plow & wing blades Item Price per foot
B-6L	3/4" X 6" LESS THAN 50 BLADES
B-6G	3/4" X 6" 50 BLADES & GREATER
C =	<b><u>COVER BLADE FOR WINGS</u></b> (see attached drawing)
C-8L	5/8" X 8" LESS THAN 50 BLADES
C-8G	5/8" X 8" 50 BLADES & GREATER
D =	<b><u>COVER BLADE FOR WINGS</u></b>
D-8L	3/4" X 8" LESS THAN 50 BLADES
D-8G	3/4" X 8" 50 BLADES & GREATER
E =	<b><u>TUNGSTEN CARBIDE BLADES FOR PLOWS AND GRADERS</u></b>
E-2	3 piece set No. D.B. 48-36-48 carbide plow blade PRICE PER SET
F =	<b><u>WING BLADE, RUBBER</u></b> (1.5" X 10" X 11") Standard Highway Punch - Slotted
F-RL	Rubber Blades LESS THAN 50 BLADES
F-RG	Rubber Blades 50 BLADES & GREATER

INDEX NO.	DESCRIPTION
	<b><u>PLOW and WING SHOES for Viking Plow</u></b>
G =	<b><u>CAST ALLOY PLOW SHOE</u></b> (2 1/4" x 8" x 14", Min. weight 36 lbs., Hole size 13/16" recessed for square head bolt.)
G-AG	Cast Alloy Abrasive 50 SHOES & GREATER
G-AL	Cast Alloy Abrasive LESS THAN 50 SHOES
H =	<b><u>CAST ALLOY WING SHOE</u></b> (12" O/C, 10 degree, Min. weight 37 lbs., Hole size 3/4", 8" Center Punched)
H-AL	Cast Alloy Abrasive LESS THAN 50 SHOES
H-AG	Cast Alloy Abrasive 50 SHOES & GREATER
I =	<b><u>NIHARD WING SHOE</u></b> (see attached drawing) (12" O/C, 10 degree, Min. weight 37 lbs., Hole size 3/4", 8" Center Punched)
I-NL	NiHard LESS THAN 50 SHOES
I-NG	NiHard 50 SHOES & GREATER
J =	<b><u>CAST STEEL, CARBIDE FRAME SHOE</u></b> (see attached drawing)
J-CL	Carbide LESS THAN 50 SHOES
J-CG	Carbide 50 SHOES & GREATER
K =	<b><u>NIHARD MOLDBOARD SHOE</u></b> (see attached drawing)
K-NL	NiHard LESS THAN 50 SHOES
K-NG	NiHard 50 SHOES & GREATER
L =	<b><u>MUSHROOM SHOES</u></b> (see attached drawing) Made of Ni-Hard Casting, 12" outside diameter x 2 3/4" high with two bolt holes.
L-AL	Mushroom Shoes LESS THAN 50 SHOES
L-AG	Mushroom Shoes 50 SHOES & GREATER

**PLOW NOSE PIECE - FIT VIKING ONE WAY PLOWS**

V =	Viking Model #10803091 (Or Equal) Used for older model plows
V-NL	LESS THAN 50
V-NG	50 & GREATER
W =	Viking Model #10805373 (Or Equal) Used for newer model plows
W-NL	LESS THAN 50
W-NG	50 & GREATER

**THE COUNTY WILL NOT WAIT LONGER THAN 30 DAYS FOR THIS DELIVERY.**

**BID FORMS OMITTED FROM  
SPECIFICATION BOOKS**

TO OBTAIN BID FORMS PLEASE CONTACT

DAWN SMITH AT 716-938-9121 EXT. 2465

OR SEND EMAIL REQUEST TO:

**[dasmith@cattco.org](mailto:dasmith@cattco.org)**

The following statement must be subscribed by the bidder and affirmed by such bidder as true, under the penalties of perjury.  
Pursuant to Section 103-d of the General Municipal Law.

### NON-COLLUSIVE BIDDING CERTIFICATION

By submission of this bid, each bidder and each person signing on behalf of any bidder certifies, and in the case of a joint bid, each party thereto certifies as to its own organization, under penalty of perjury, that to the best of knowledge and belief:

The prices in this bid have been arrived at independently without collusion, consultation, communication, or agreement, for the purpose of restricting competition, as to any matter relating to such prices with any other bidder or with any competitor;

Unless otherwise required by law, the prices which have been quoted in this bid have not been knowingly disclosed by the bidder and will not knowingly be disclosed by the bidder prior to opening, directly or indirectly, to any other bidder or to any competitor, and

No attempt has been made or will be made by the bidder to induce any other person, partnership, or corporation to submit or not to submit a bid for the purpose of restricting competition.

(For use of individual bidder)

IN WITNESS WHEREOF, I, \_\_\_\_\_, doing business under the style and name of \_\_\_\_\_ at \_\_\_\_\_ have hereunto subscribed my name under the penalties of perjury at \_\_\_\_\_ on this \_\_\_\_\_ day of \_\_\_\_\_, 20 \_\_\_\_.

\_\_\_\_\_

d/b/a \_\_\_\_\_

(For use of partnership bidder)

IN WITNESS WHEREOF, this non-collusive bidding certification has been subscribed, under the penalties of perjury, at \_\_\_\_\_ on this \_\_\_\_\_ day of \_\_\_\_\_, 20 \_\_\_\_, by \_\_\_\_\_, one of the partners or co-partners of the partnership composed of \_\_\_\_\_ and \_\_\_\_\_ doing business under the style, partnership, and firm name of \_\_\_\_\_ at \_\_\_\_\_.

\_\_\_\_\_  
Partnership Name

By \_\_\_\_\_  
Co-Partner

(For use of corporate bidder)

RESOLVED, that \_\_\_\_\_ (name of corporation) be authorized to sign and submit the bid or proposal of this corporation for the following project \_\_\_\_\_ and to include in such bid or proposal the certificate as to non-collusion required by Section 103-d of the General Municipal Law as the act and deed of such corporation, and for any inaccuracies or misstatements in such certificate, this corporate bidder shall be liable, under the penalties of perjury.

The foregoing is a true and correct copy of the Resolution adopted by \_\_\_\_\_ Corporation at a meeting of its board of directors held on the \_\_\_\_\_ day of \_\_\_\_\_, 20 \_\_\_\_.

Dated at \_\_\_\_\_ on this \_\_\_\_\_ day of \_\_\_\_\_, 20 \_\_\_\_.

(SEAL OF THE CORPORATION)

\_\_\_\_\_  
Secretary

\_\_\_\_\_  
Name of Bidder

By \_\_\_\_\_  
Title

## LEGAL STATUS INFORMATION

To facilitate correct drawing and execution of contract, bidder shall supply full information concerning legal status:

FIRM NAME: \_\_\_\_\_

Federal ID No.: \_\_\_\_\_

PRINCIPAL OFFICE:

Street \_\_\_\_\_

City, State, Zip \_\_\_\_\_

Telephone \_\_\_\_ (\_\_\_\_) \_\_\_\_\_ Fax \_\_\_\_ (\_\_\_\_) \_\_\_\_\_

LOCAL OFFICE:

Street \_\_\_\_\_

City, State, Zip \_\_\_\_\_

Telephone \_\_\_\_ (\_\_\_\_) \_\_\_\_\_ Fax \_\_\_\_ (\_\_\_\_) \_\_\_\_\_

CONTRACT TO BE SENT TO: Principal Office \_\_\_\_\_ Local Office \_\_\_\_\_

CHECK ONE: Corporation \_\_\_\_\_ Partnership \_\_\_\_\_ Individual \_\_\_\_\_

(Incorporated under the Laws of the State of \_\_\_\_\_)

(If foreign corporation, state if authorized to do business in the State of New York:

Yes \_\_\_\_\_ No \_\_\_\_\_ Not Applicable \_\_\_\_\_)

TRADE NAMES:

\_\_\_\_\_

NAMES AND ADDRESSES OF PARTNERS:

\_\_\_\_\_

\_\_\_\_\_

\_\_\_\_\_

NAME, TITLE, AND ADDRESS OF PERSON AUTHORIZED TO SIGN CONTRACT ON BEHALF OF BIDDER:

Name: \_\_\_\_\_

Title: \_\_\_\_\_

Address: \_\_\_\_\_

PLEASE TYPE OR PRINT

BID FOR PERFORMANCE OF CONTRACT WITH  
CATTARAUGUS COUNTY LEGISLATURE  
LITTLE VALLEY, NEW YORK

TO: Cattaraugus County Legislature, Little Valley, New York, herein after called the County.

The undersigned, desiring to interpose a bid to provide services for **Cutting Edges and Shoes for Graders, Plows and Wings** for Cattaraugus County Department of Public Works, does hereby accept all terms, conditions, and agreements contained and set forth in the, Minimum Specifications, Non-Collusive Bidding Certification, Legal Status Information and Bid for Performance of Contract with Cattaraugus County Legislature and does hereby certify, agree and propose as follows:

The undersigned declares that he/she has examined all of the attached documents, and hereby proposes and agrees that, if this bid is accepted, he/she will contract with the County, such contract incorporating the provisions of the documents attached hereto, to furnish all the materials and services and do all the work specified in the attached documents in the manner and time herein specified and according to the requirements as herein set forth, and to take in full payment therefore the bid prices set forth on the preceding specification sheets.

If this proposal is accepted by the County and the undersigned fails to contract as aforesaid, within ten days (not including Sunday) from the date of notice from the County to him/her, then the County may at its option, determine that the bidder has abandoned his/her right to enter into the contract and thereupon the bid and acceptance shall be null and void.

The full name and residences of all persons and parties interested in the foregoing bid as principals are as follows:  
(Individuals or partnership bids only)

---

---

---

INDIVIDUAL, PARTNERSHIP OR CORPORATE USE

The undersigned certifies, under penalty of perjury, that he is fully authorized to sign this bid.

Name and Address of Bidder:

---

---

---

Authorized Signature and Title:

---

Signature

---

Title

---

Date

---

Pursuant to State Finance Law §165-a, the Commissioner of General Services is required to develop a list of persons it determines engage in investment activities in Iran, which is defined as provision of goods, services or credit of \$20,000,000 or more, relating to the energy sector.

General Municipal Law §103-g(4) states as follows:

Every bid or proposal hereafter made to a political subdivision of the state or any public department, agency or official thereof where competitive bidding is required by statute, rule, regulation or local law, for work or service performed or to be performed or goods sold or to be sold, shall contain the following statement subscribed by the bidder and affirmed by such bidder as true under penalties of perjury.

The below signed bidder affirms the following as true under penalties of perjury:

- a. “By submission of this bid, the bidder identified herein and each person signing on behalf of the bidder certifies, and in the case of a joint bid each party thereto certifies as to its own organization, under penalty of perjury, that to the best of its knowledge and behalf that this bidder is not on the list created pursuant to paragraph (b) of subdivision 3 of Section 165-a of the state finance law.”

Corporate or Company Name

\_\_\_\_\_

By:

Signature

Title

Sworn to before me this

\_\_\_\_ day of \_\_\_\_\_, 20 \_\_\_\_

Notary Public